

NovAseptic® Connector NovAseptic® Sample Port

Catalogue Number NAV-4-2

NovAseptic® Sample Port Configuration

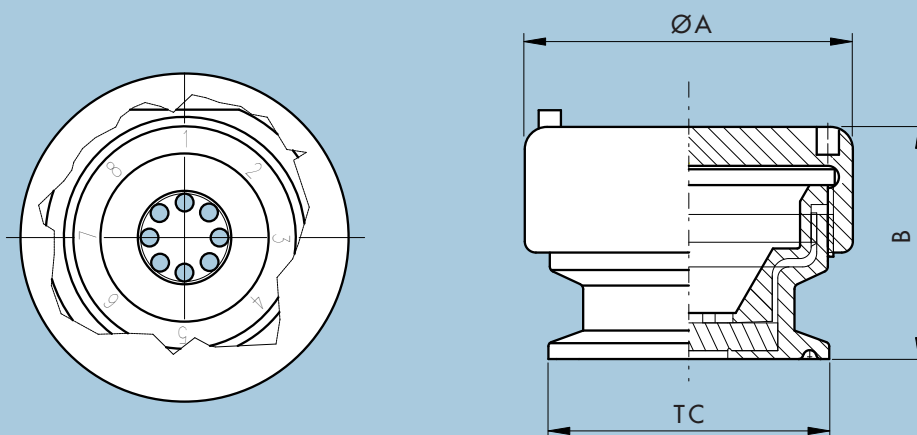

Nominal Dimensions in mm (in.)

NAV-#-#	A	B	TC
NAV-4-2	59.0 (2.323)	42.0 (1.654)	50.5 (1.988)

Specifications

Net Weight (approximate)

NovAseptic Sample Port	NAV-4-2
Weight kg (lb)	0.4 (0.88)

Material

	Body Stainless Steel in Compliance with		Membrane	O-ring
Material Code	316L	EN 1.4404	Platinum Cured Silicone	PTFE
Technical Requirements	ASME® SA-479	EN 10272	-	-

Spare Parts

	NAV-4-2	
Membrane	NAV-4-14	NAV-4-14/10
	1 pcs	10 pcs

Specifications

Product Contact Surface Roughness: $R_a < 0.5\mu\text{m}$ (20 μin)

Design Temperature: -80 to 200 °C (-112 to 392 °F)

Design Pressure: -1 to 7 bar(g) (-14.5 to 101 psi(g))

Note! The applied gasket (not included) may have different design temperature and/or pressure limits than the NovAseptic Sample Port. The weakest component in the assembled product determines the maximum design temperature and pressure limits.

Labeling: Each NovAseptic Sample Port is labeled for full LOT traceability and heat No. according to Millipore QA routines.

Packaging: All open ends on the NovAseptic Sample Port are protected with plastic covers on delivery. The NovAseptic Sample Port is pre-assembled and packaged in a closed box.

Quality Control: Millipore Quality Assurance System guarantees the control and traceability at all stages of the manufacturing.

In Compliance With: The NovAseptic Connector is designed to meet requirements for Europe PED Directive 97/23/EC, AFS 1999:4 and AD2000. Design review includes construction and internal pressure. Calculations/analysis are conducted with a gasket of silicone or EPDM.

Options: For non-standard NovAseptic Sample Port Options, please contact Millipore for further information.

To Place an Order or Receive Technical Assistance

For additional information call your nearest Millipore office or visit us at www.millipore.com.

In the U.S. and Canada, call toll-free 1-800-MILLIPORE (1-800-645-5476). In the U.S., Canada and Puerto Rico, fax orders to 1-800-MILLIFX (1-800-645-5439).

MILLIPORE

Millipore and NovAseptic are registered trademarks of Millipore Corporation or an affiliated company.

ASME is a registered trademark of the American Society of Mechanical Engineers.

Specifications subject to change without notice.

Lit. No. SP1006EN00 Rev. -, 10/2006. Replaces DS-321

© 2006 Millipore Corporation. All rights reserved.