

Spare Parts List

Mobius® MIX and Power MIX Single-Use Mixing Systems



The life science business of
Merck operates as MilliporeSigma
in the US and Canada.

Part number	Catalogue number	Description	Mobius® Power MIX	Mobius® MIX	Preventive maintenance (PM*, Critical**, Other)
1	MIXSST0109442	Quick-connect coupling, male, 3/4" NPT	x	x	Critical
2	MIXSST0109441	Quick-connect coupling, female, 3/4" NPT	x	x	Critical
3	SPKHW000001	Pressure relief valve, 3/4" inlet, 1" outlet, 100 PSI—LESER	x		Critical
4	SPKHW000002	Pressure relief valve, 1/2" (0–100 psi)—NEPTUNE	x		Critical
5	SPKHW000003	Pressure gauge, 0–100 psi 1/8" NPT—McMASTERCarr	x		Critical
6	SPKHW000004	4" stainless swivel caster with hi-temp wheel, brakes—COLSON	x	x	Critical
7	SPKHW000005	Levelling feet—ATLAS	x	x	Critical
8	SPKHW000006	Multimount load cell sensor 0745A, 110 kg, 15 ft, C3—METTLER	x	x	Critical
8	SPKHW000007	Multimount load cell sensor 0745A, 220 kg, 15 ft, C3—METTLER	x	x	Critical
8	SPKHW000008	Multimount load cell sensor 0745A, 550 kg, 15 ft, C3—METTLER	x	x	Critical
8	SPKHW000009	Multimount load cell sensor 0745A, 1100 kg, 15 ft, C3—METTLER	x	x	Critical
8	SPKHW000010	Multimount load cell sensor 0745A, 2200 kg, 15 ft, C3—METTLER	x		Critical
9	SPKHW000011	Ringmount load cell sensor, RLC, 250 kg, C3—METTLER	x		Critical
9	SPKHW000012	Ringmount load cell sensor, RLC, 500 kg, C3—METTLER	x		Critical
9	SPKHW000013	Ringmount load cell sensor, RLC, 1000 kg, C3—METTLER	x		Critical
9	SPKHW000014	Ringmount load cell sensor, RLC, 2000 kg, C3—METTLER	x		Critical
10	SPKHW000016	Temperature sensor 1xPT100, M12 base—JUMO	x		Critical
11	SPKHW000017	Temperature sensor OMEGA RTD-809, TC 2"—OMEGA	x		Critical
12	SPKHW000018	4" stainless swivel caster with hi-temp wheel—COLSON		x	Critical
13	SPKHW000019	Levelling caster—ATLAS		x	Critical
14	SPKHW000015	Jacking tool for SWB505/605 Size 2—METTLER	x	x	Other

* Preventive Maintenance (PM) parts are subject to wear and tear. Under average usage conditions, they should be replaced at least once per year. A risk assessment based on the specific system usage and production conditions may indicate replacement of some or all of these parts more frequently.

** Critical parts have been identified as most critical to avoiding system downtime and are recommended to be kept in stock for immediate availability.

For both PM and critical parts, stock recommendation is 1 part per unit.

Mobius® Power MIX—Illustrated views

Sizes: 100 L, 200 L, and 500 L

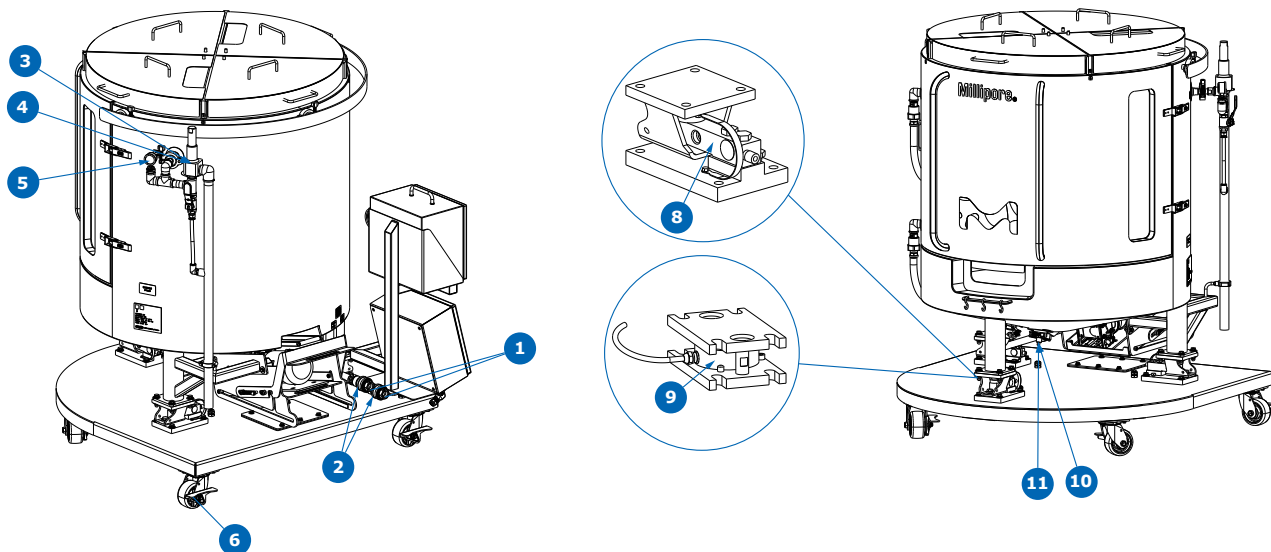

Sizes: 1000 L and 2000 L

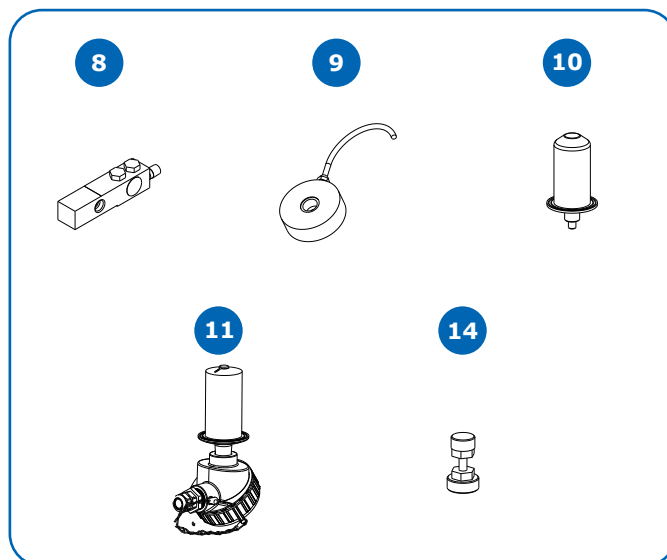
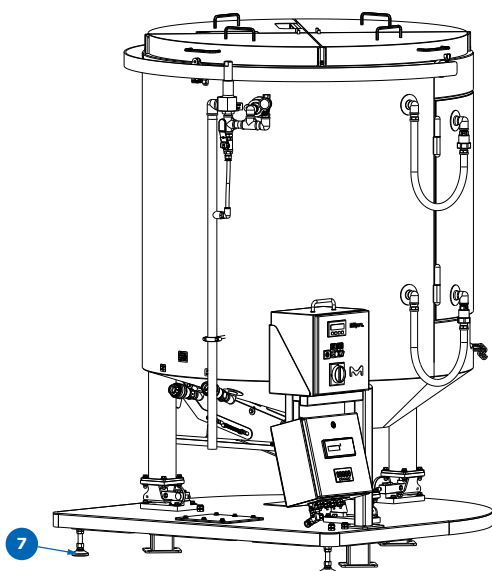

Mobius® MIX—Illustrated views

Sizes: 100 L, 200 L, and 500 L

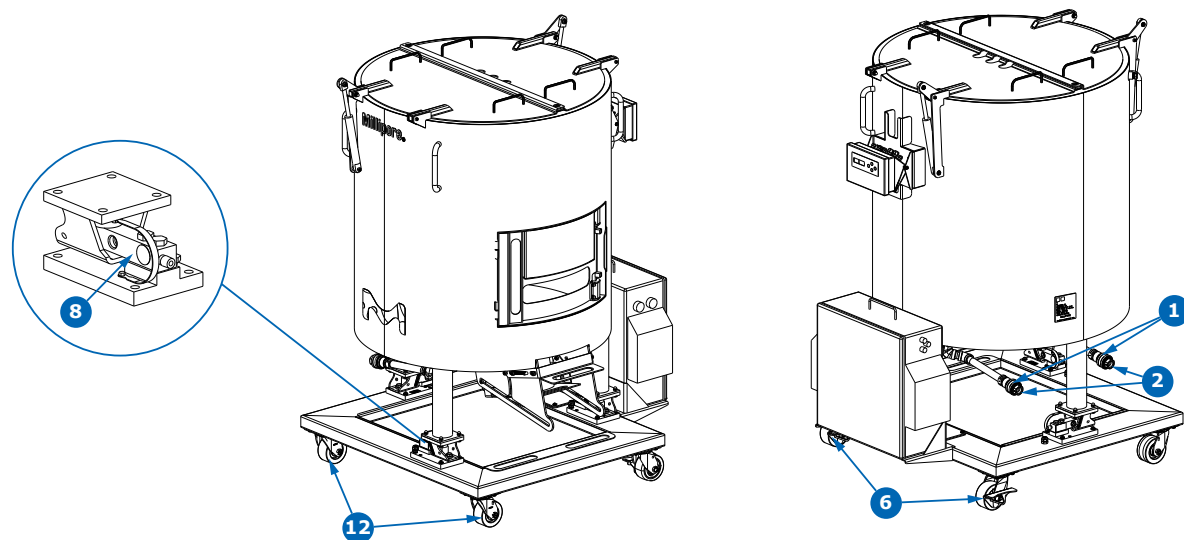

Sizes: 1000 L and 2000 L

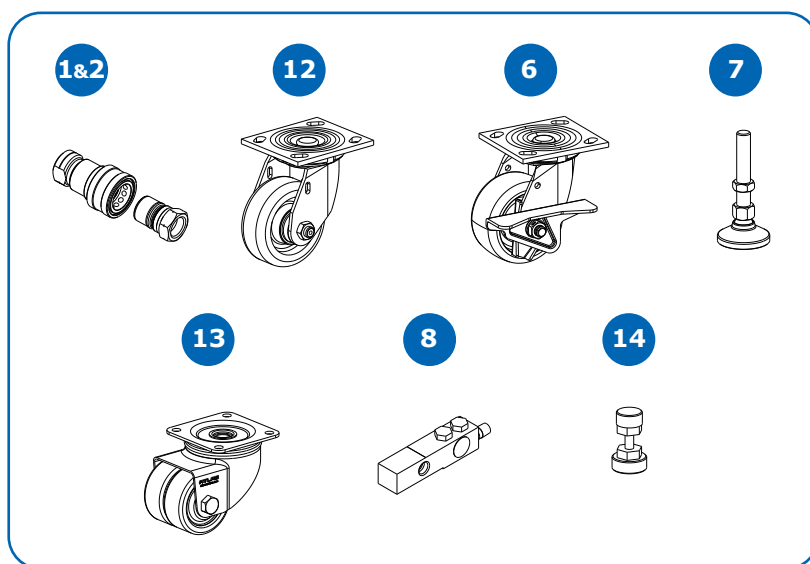
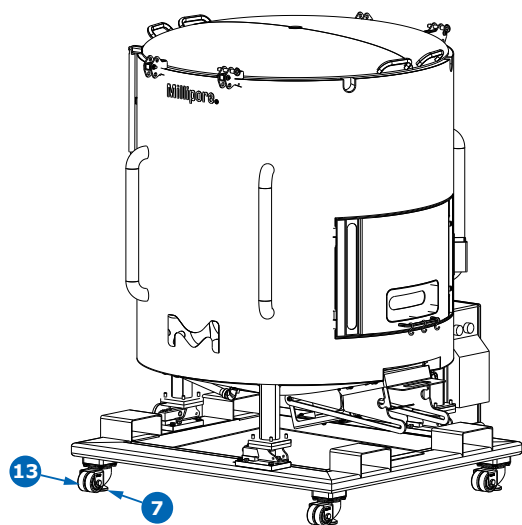

Merck KGaA
Frankfurter Strasse 250
64293 Darmstadt, Germany

SigmaAldrich.com

