

Spare Parts List



Mobius® Chrom Systems

- Mobius® Chrom 2 System
- Mobius® Chrom 10 System
- Mobius® Chrom 20 System (available with in-line dilution)

Table of contents

Spare Parts List 3-6

Illustrated views

System Overview 7

Base Cart Parts 8-9

Pump Cart Parts..... 10-13

Ebox Parts..... 14-15

Clamshell Parts 16-18

Instrumentation parts..... 19



The Life Science business of Merck operates as MilliporeSigma in the U.S. and Canada.

Spare Parts

To help you select and manage the spare parts required for your system, our experts have performed a risk assessment to determine which parts to keep in stock.

The risk assessment is based on our experience; each customer must perform their individual risk assessment for their process, to check the alignment with our strategy and review the stock requirements accordingly.

As a result of this risk assessment, we defined 3 categories of spare parts:

Type of parts	Description	Stock recommendation
Preventive maintenance parts	These are parts that are subject to wear and tear and that we recommend replacing on a regular basis. Under average usage conditions, these parts should be replaced at least once per year. A risk assessment based on the specific system usage and production conditions may result in a requirement to replace some or all of these parts more frequently. Not replacing wear and tear parts as recommended can impact system functionality and may result in system shutdown.	1 part per unit
Critical parts	These parts have been identified as most critical to avoiding system downtime and are recommended to be kept in stock for immediate availability.	1 part per unit
All other parts	All other individual parts.	Risk-based customer decision

Based on our risk analysis, preventive maintenance and critical spare parts are essential to keep your equipment running. We recommend keeping preventive maintenance and critical spare parts in stock. Make sure you order the preventive maintenance spare part “Pump shaft bearing cap” before service execution.

Ordering information for Flexware® assemblies service kits

Catalogue Number	SERFXWKITXM02	SERFXWKITXM10	SERFXWKITXM20	SERFXWKITXM20ILD
Description	Mobius®, Chrom 2 system Flexware® service kit	Mobius®, Chrom 10 system Flexware® service kit	Mobius®, Chrom 20 system Flexware® service kit	Mobius®, Chrom 20 system with (In-line dilution option) Flexware® service kit

Notes:

- Service kits to be ordered separately prior the qualification services (FAT or IQ/OQ or Full Test Package) or yearly maintenance services included in the System Service Reliance Plans.
- Unless stated otherwise, default quantity (qty) is 1; you may need to order multiple units based on your requirements.
- # symbols indicate the part is illustrated in this document.
- “Chrom 20 ILD” stands for “Chrom 20 Inline Dilution”.

Warning: This document only applies to systems mentioned in the Mobius® Chrom Systems data sheet (MK_DS13075EN) available at [SigmaAldrich.com](https://www.sigmaaldrich.com).

Spare Parts List

Item	Catalogue Number	Description	PM*/Critical**/Other	Field service required	Frequency	Mobius® Chrom 2 System	Mobius® Chrom 10 System	Mobius® Chrom 20 System	Mobius® Chrom 20 System (In-line dilution)
#1	SPKGENPNE001	Festo Filter cartridge MS4-LFP-E	PM	No	Every 12 months	×	×	×	×
#2	SPKGENELC045	Rittal filter mat SK 3171.100 pack of 5	PM	No	Every 12 months	×	×	×	×
#3	SPKMBSMTCS040	Mobius® Chrom 20 Clamshell Valve Pads Kit	PM	No	Every 6 months			×	×
#4	SPKMBSMTCS019	Mobius® Chrom 10 Clamshell, Valve Pads Kit	PM	No	Every 6 months		×		
#5	SPKMBSMTCS014	Mobius®Chrom 2 Clamshell Valve Pads Kit	PM	No	Every 6 months	×			
#6	SPKMBSMTPUMP013	Pump QF1200-5 Shaft Bearing Cap Unit	PM	For installation	Every 1000 h or at least once a year		×	×	×
#7	SPKMBSMTPUMP012	Pump QF150-5 Shaft Bearing Cap Unit	PM	For installation	Every 1000 h or at least once a year	×			
#8	SPKMBSMTSEN001	UV Lamp	PM	No	Every 12 months	×	×	×	×
#9	SPKMBSMTBASE015	Set of Balls and O-Rings	PM	No	Every 6 months	×	×	×	×
#10	SPKGENELC044	Rittal filter mat SK 3321.700 pack of 5	PM	No	Every 12 months	×	×	×	×
#11	SPKMBSMTBASE038	Power Supply 100–230 VAC / 24 VDC 10A	Critical	No	As required	×	×	×	×
#12	SPKMBSMTBASE039	Base Cart I/O Modules Replacement Kit 1	Critical	For installation	As required	×	×	×	×
#13	SPKMBSMTBASE040	Base Cart Cube67 Bus Node	Critical	For installation	As required	×	×	×	×
#14	SPKMBSMTCS037	Mobius® Chrom 20 Clamshell Cube67 Bus Node	Critical	For installation	As required			×	×
#15	SPKMBSCHRAUT001	Mobius® Chrom 2 Clamshell Cube67 Bus Node	Critical	For installation	As required	×			
#16	SPKMBSCHRAUT002	Mobius® Chrom 10 Clamshell Cube67 Bus Node	Critical	For installation	As required		×		
#17	SPKMBSMTBASE041	Base Cart PLC Power Supply	Critical	No	As required	×	×	×	×
#18	please contact us	Mobius Chrom & TFF HMI	Critical	For installation	As required	×	×	×	×
#19	please contact us	Mobius® Chrom & TFF Manageable Switch	Critical	For installation & setup	As required	×	×	×	×
#20	SPKGEN003	Ebox Fan	Critical	No	As required	×	×	×	×
#21	SPKMBSMTBBL001	Mobius® Chrom Bubble Trap Level Sensor Kit	Critical	For installation & setup	As required	×	×	×	×
#22	SPKMBSMTCS038	Clamshell NC/NO Pinch Valve 5/8"	Critical	For installation	As required			×	×
#23	SPKMBSMTCS039	Mobius® Chrom 20 Clamshell Connector Clips Kit	Critical	No	As required			×	×
#24	SPKMBSMTCS041	Clamshell NO PCV Pinch Valve 5/8"	Critical	For installation	As required			×	×
#25	SPKMBSCHRVLV001	Clamshell NC/NO Pinch Valve 3/8"	Critical	For installation	As required		×		
#26	SPKMBSMTCS018	Mobius® Chrom 10 Clamshell Connector Clips Kit	Critical	No	As required		×		
#27	SPKMBSCHRVLV002	Clamshell NO PCV Pinch Valve 3/8"	Critical	For installation	As required		×		
#28	SPKMBSMTCS015	Clamshell NC/NO Pinch Valve 1/4"	Critical	For installation	As required	×			
#29	SPKMBSMTCS013	Mobius® Chrom 2 Clamshell Connector Clips Kit	Critical	No	As required	×			
#30	SPKMBSMTCS016	Clamshell NO PCV Pinch Valve 1/4"	Critical	For installation	As required	×			
#31	SPKMBSMTCS022	Chrom Clamshell Valve terminal MPA	Critical	For installation	As required	×	×	×	×
#32	SPKMBSMTCS025	Pressure Transmitter and Switch Kit	Critical	For installation & setup	As required	×	×	×	×
#33	SPKMBSMTCS026	Pressure Transmitter	Critical	No	As required	×	×	×	×
#34	SPKMBSMTPCART006	Power Supply 100–240 VAC / 48 VDC 12.5 A	Critical	No	As required	×	×	×	×
35	SPKMBSMTFLW007	Krohne Flowmeter Cable	Critical	No	As required	×	×	×	×

Means that the part is illustrated.

* Preventive Maintenance (PM) parts are subject to wear and tear. Under average usage conditions, they should be replaced at least once per year. A risk assessment based on the specific system usage and production conditions may indicate replacement of some or all of these parts more frequently.

** Critical parts have been identified as most critical to avoid system downtime and are recommended to be kept in stock for immediate availability. For both PM and critical parts stock recommendation is 1 part per unit. For custom or additional spare parts, please contact your local sales representative.

Spare Parts List (Continued)

Item	Catalogue Number	Description	PM*/Critical**/Other	Field service required	Frequency	Mobius® Chrom 2 System	Mobius® Chrom 10 System	Mobius® Chrom 20 System	Mobius® Chrom 20 System (In-line dilution)
#36	SPKMBSMTFLW011	Chrom 10 & 20 SU Flowmeter Converter	Critical	No	As required		x	x	x
#37	SPKMBSMTFLW012	Krohne Flexmag 4050 C 3/8–1/2 in Qmax 22 lpm	Critical	No	As required			x	x
#38	SPKMBSMTFLW009	Krohne Flexmag 4050 C 3/8–1/2 in Qmax 20 lpm	Critical	No	As required		x		
#39	SPKMBCHRINS001	Chrom 2 SU Flowmeter Converter	Critical	No	As required	x			
#40	SPKGENINS028	Krohne Flexmag 4050 C 1/4 in Qmax 3 lpm	Critical	No	As required	x			
#41	SPKMBSMTFLW013	Chrom Krohne Flowmeter Support	Critical	No	As required	x	x	x	x
#42	SPKMBCHRINS002	Chrom 20 ILD Levitronix Flow Converter	Critical	No	As required				x
43	SPKMBCHRINS003	Chrom 20 ILD Levitronix Flowmeter Cable	Critical	No	As required				x
#44	SPKMBSMTMNFLD006	Chrom Manifold Valve terminal MPA	Critical	For installation	As required	x	x	x	x
#45	SPKMBSMTMNFLD013	Chrom 20 Manifold Pneumatic Valve Kit	Critical	For installation	As required			x	x
#46	SPKMBSMTMNFLD007	Chrom 2 & 10 Manifold Pneumatic Valve Kit	Critical	For installation	As required	x	x		
#47	SPKMBSMTTMTR001	Converter C8480 Kit	Critical	For installation & setup	As required	x	x	x	x
#48	SPKMBSMTSEN003	Dual beam 280–300 nm UV sensor	Critical	No	As required	x	x	x	x
#49	SPKCBS000INS018	Dual beam 254–280 nm UV sensor	Critical	No	As required	x	x	x	x
#50	SPKMBSMTGEN008	I/O Modules Replacement Kit 2	Critical	For installation	As required	x	x	x	x
#51	SPKGENINS012	Hamilton EasyFerm Bio HB Arc 120 VP6 pH1	Critical	No	As required	x	x	x	x
#52	SPKGENINS013	Hamilton EasyFerm Bio HB Arc 120 VP6 pH2	Critical	No	As required	x	x	x	x
#53	please contact us	Hamilton Arc Module SU pH1	Critical	No	As required	x	x	x	x
#54	please contact us	Hamilton Arc Module SU pH2	Critical	No	As required	x	x	x	x
#55	SPKGEN003	FESTO air solenoid valve 575271	Critical	For installation	As required	x	x	x	x
#56	SPKGENINS037	Optek ACF60-SU-35 conductivity sensor	Critical	No	As required	x	x	x	x
#57	SPKMBSMTBASE036	Base Cart HMI Gaz Module	Other	For installation	As required	x	x	x	x
#58	SPKMBSMTBASE037	Base Cart HMI Bearing & Cap	Other	For installation	As required	x	x	x	x
#59	SPKGEN001	Lightning M	Other	No	As required	x	x	x	x
#60	SPKMBSMTPCART010	Pump Cart Mechanical Kit	Other	No	As required	x	x	x	x
61	SPKMBSMTGEN007	Interconnection Cables Kit	Other	No	As required	x	x	x	x
#62	SPKMBCHRFRM001	Chrom Flowmeter 2 Outlet Flexware Support	Other	No	As required	x	x	x	
63	SPKMBPWCCH	Power Cord CH	Other	No	As required	x	x	x	x
64	SPKMBPWCEU	Power cord EU	Other	No	As required	x	x	x	x
65	SPKMBPWCJP	Power cord JP	Other	No	As required	x	x	x	x
66	SPKMBPWCKR	Power cord KR	Other	No	As required	x	x	x	x
67	SPKMBPWCNA	Power cord NA	Other	No	As required	x	x	x	x
68	SPKMBPWCUK	Power cord UK	Other	No	As required	x	x	x	x
69	SPKMBPWCCN	Power cord CN	Other	No	As required	x	x	x	x

Means that the part is illustrated.

* Preventive Maintenance (PM) parts are subject to wear and tear. Under average usage conditions, they should be replaced at least once per year. A risk assessment based on the specific system usage and production conditions may indicate replacement of some or all of these parts more frequently.

** Critical parts have been identified as most critical to avoid system downtime and are recommended to be kept in stock for immediate availability. For both PM and critical parts stock recommendation is 1 part per unit. For custom or additional spare parts, please contact your local sales representative.

Spare Parts List (Continued)

Bill of Material of I/O Modules Replacement Kit 2

Item	Qty	Description
#50A	1×	CUBE20 terminal module DIO8
#50B	1×	CUBE20 E/A module 4AI U/I
#50C	1×	CUBE67 extension module DI8 E 4× M12
#50D	1×	CUBE67 extension module DIO8 E 4× M12
#50E	1×	CUBE67 extension module AI4 E 4× M12 (I)
#50F	1×	CUBE67 extension module AO4 E 4× M12 (I)
#50G	1×	CUBE20 module DI16 DO16
#50H	1×	CUBE20 terminal module AO4 U/I
#50I	1×	CUBE67 compact module AO4 C 4× M12 (I)
#50J	1×	CUBE67 compact module AI4 C 4× M12 (I)

Means that the part is illustrated.

* Preventive Maintenance (PM) parts are subject to wear and tear. Under average usage conditions, they should be replaced at least once per year. A risk assessment based on the specific system usage and production conditions may indicate replacement of some or all of these parts more frequently.

** Critical parts have been identified as most critical to avoid system downtime and are recommended to be kept in stock for immediate availability. For both PM and critical parts stock recommendation is 1 part per unit. For custom or additional spare parts, please contact your local sales representative.

System Overview

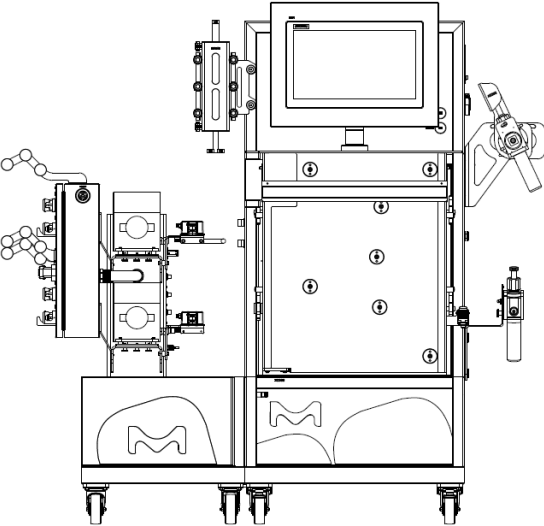

Mobius® Chrom 2

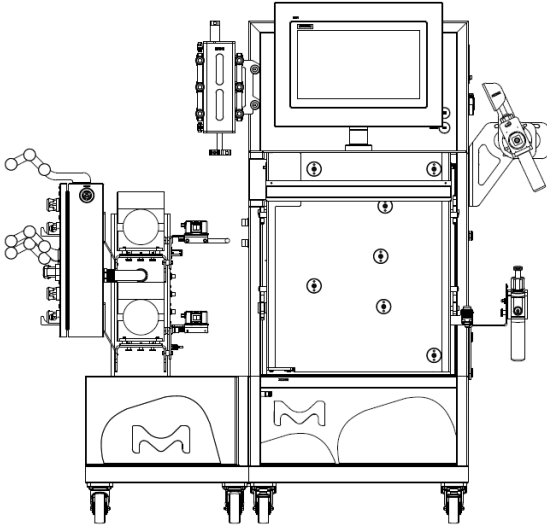

Mobius® Chrom 10

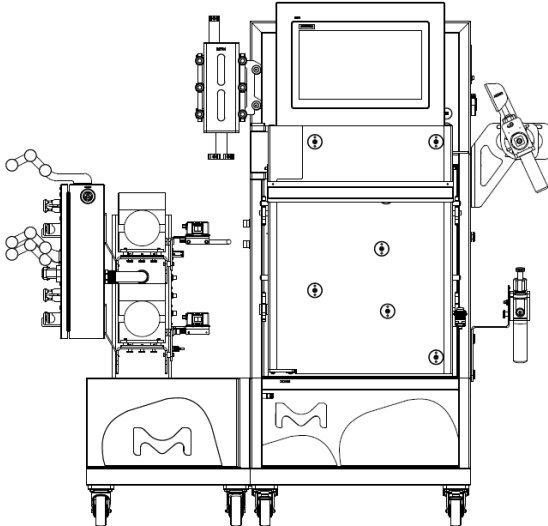

Mobius® Chrom 20

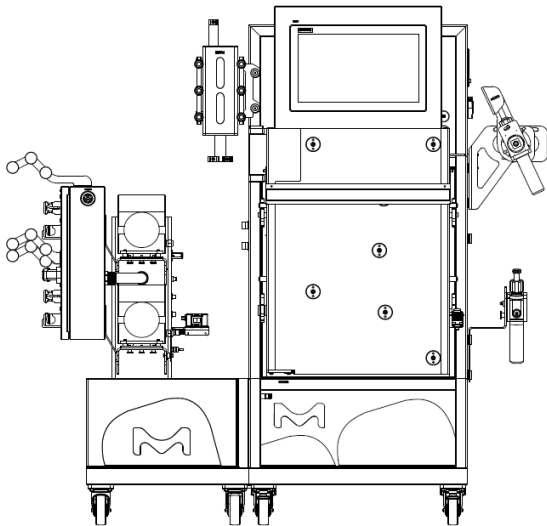

Mobius® Chrom 20
Inline Dilution

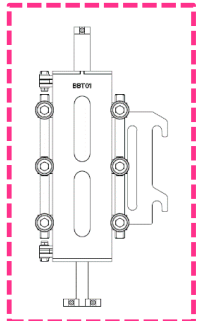
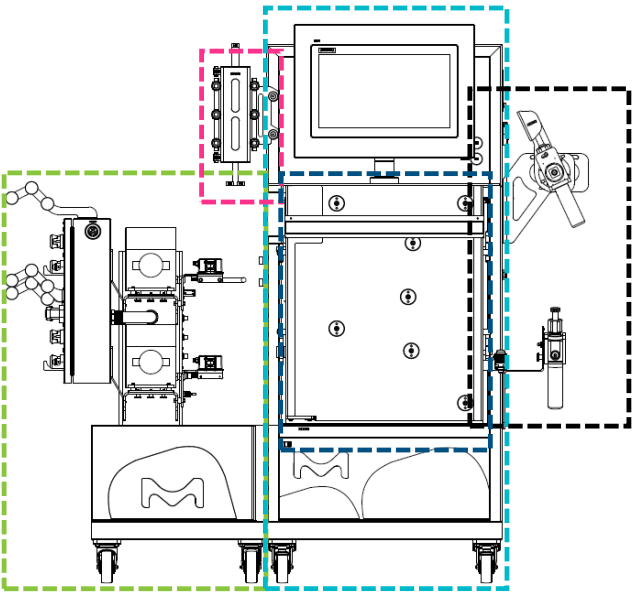

Bubble Trap

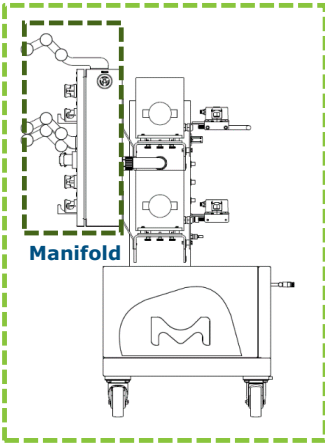

Pump Cart

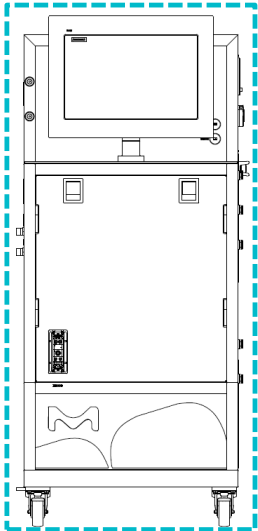

Base Cart

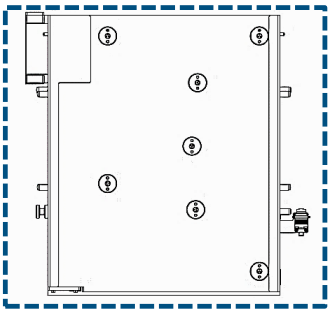

Clamshell

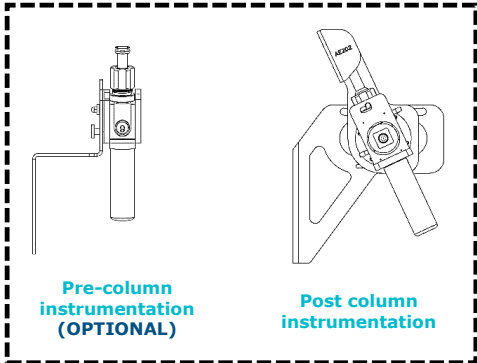

Instrumentation

Sub-Assemblies Details

Base Cart Parts

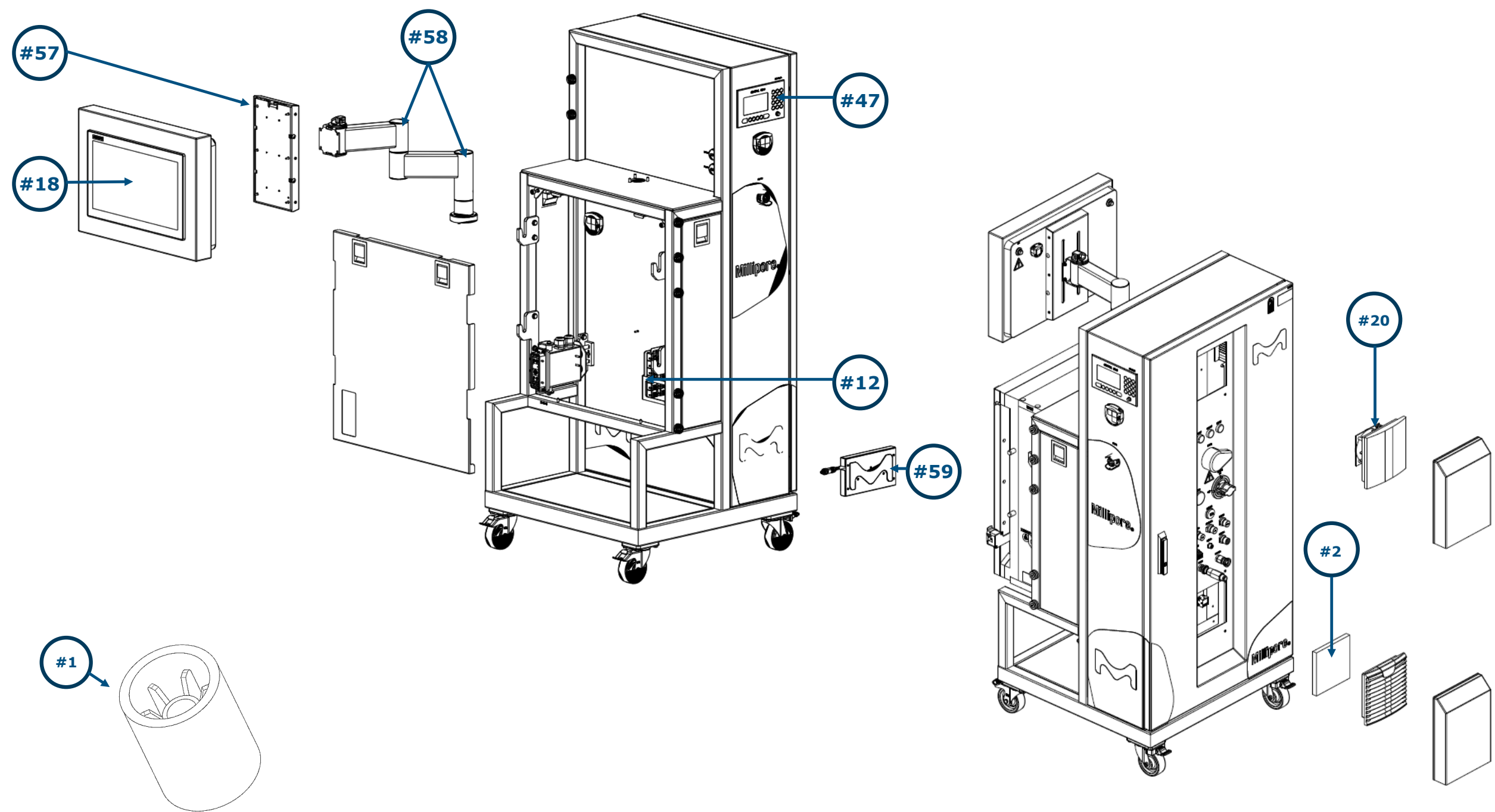

Sub-Assemblies Details

Base Cart Parts

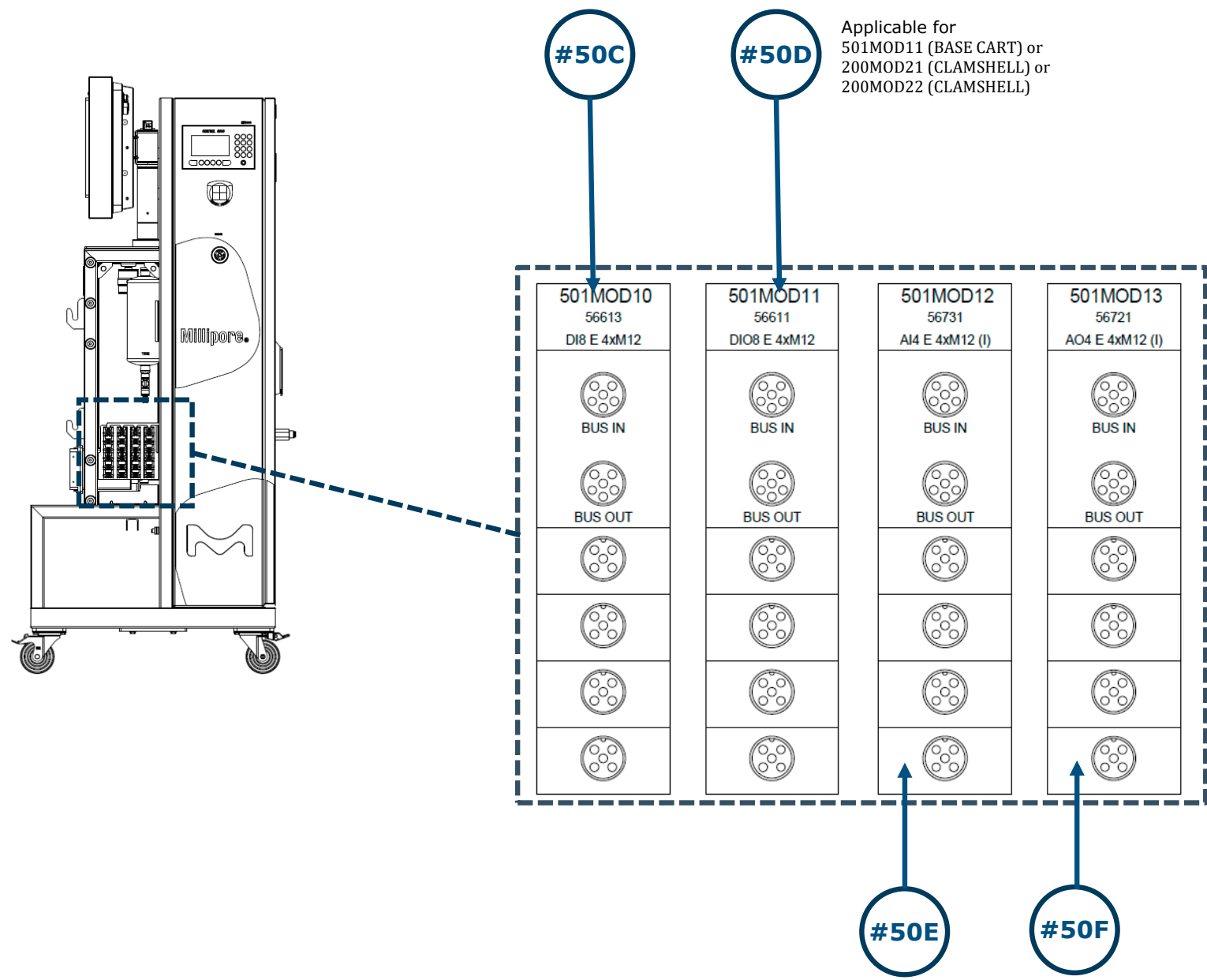

Sub-Assemblies Details

Base Cart Parts

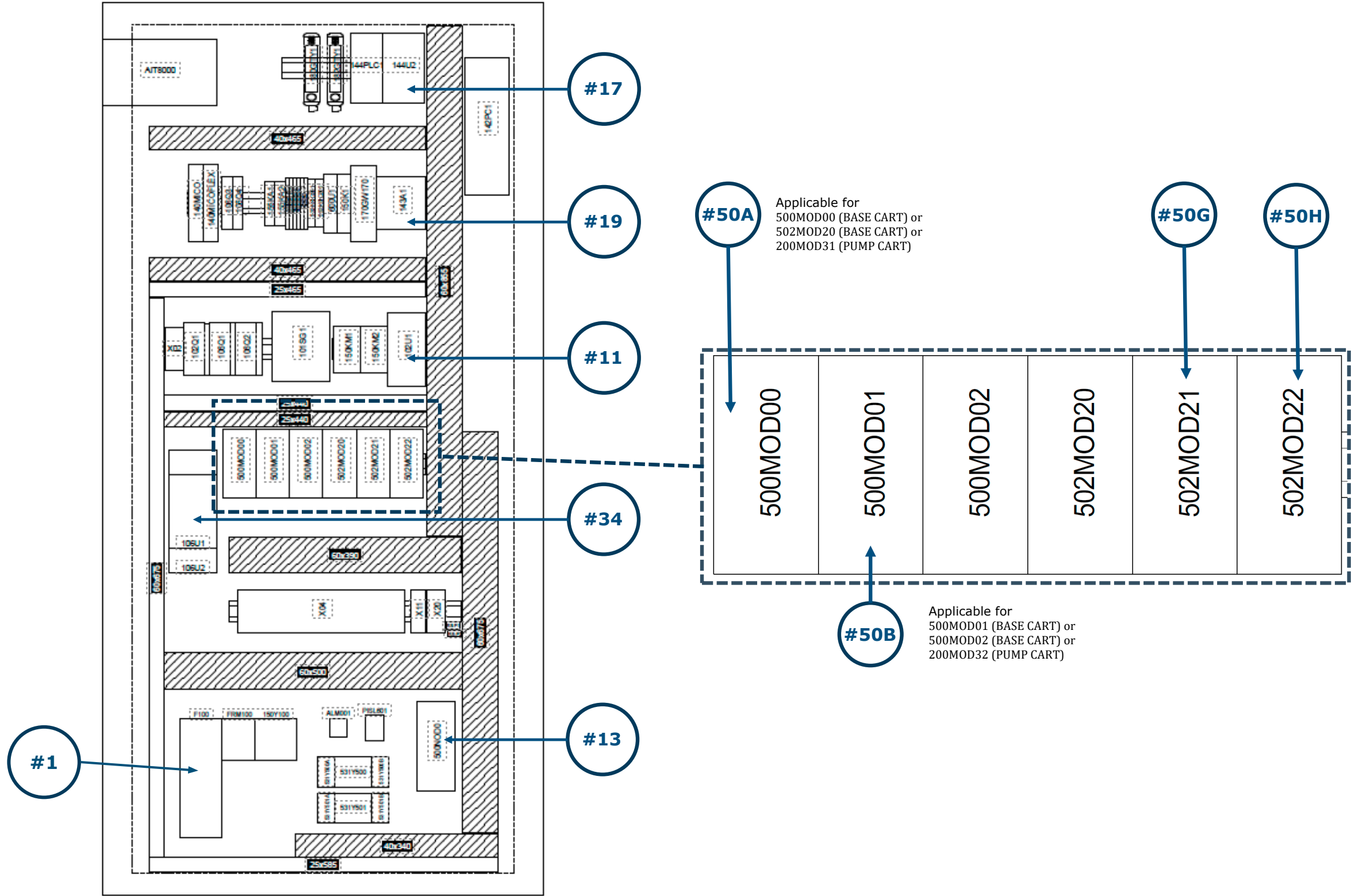

Sub-Assemblies Details

Mobius® Chrom 2 Pump Cart Parts

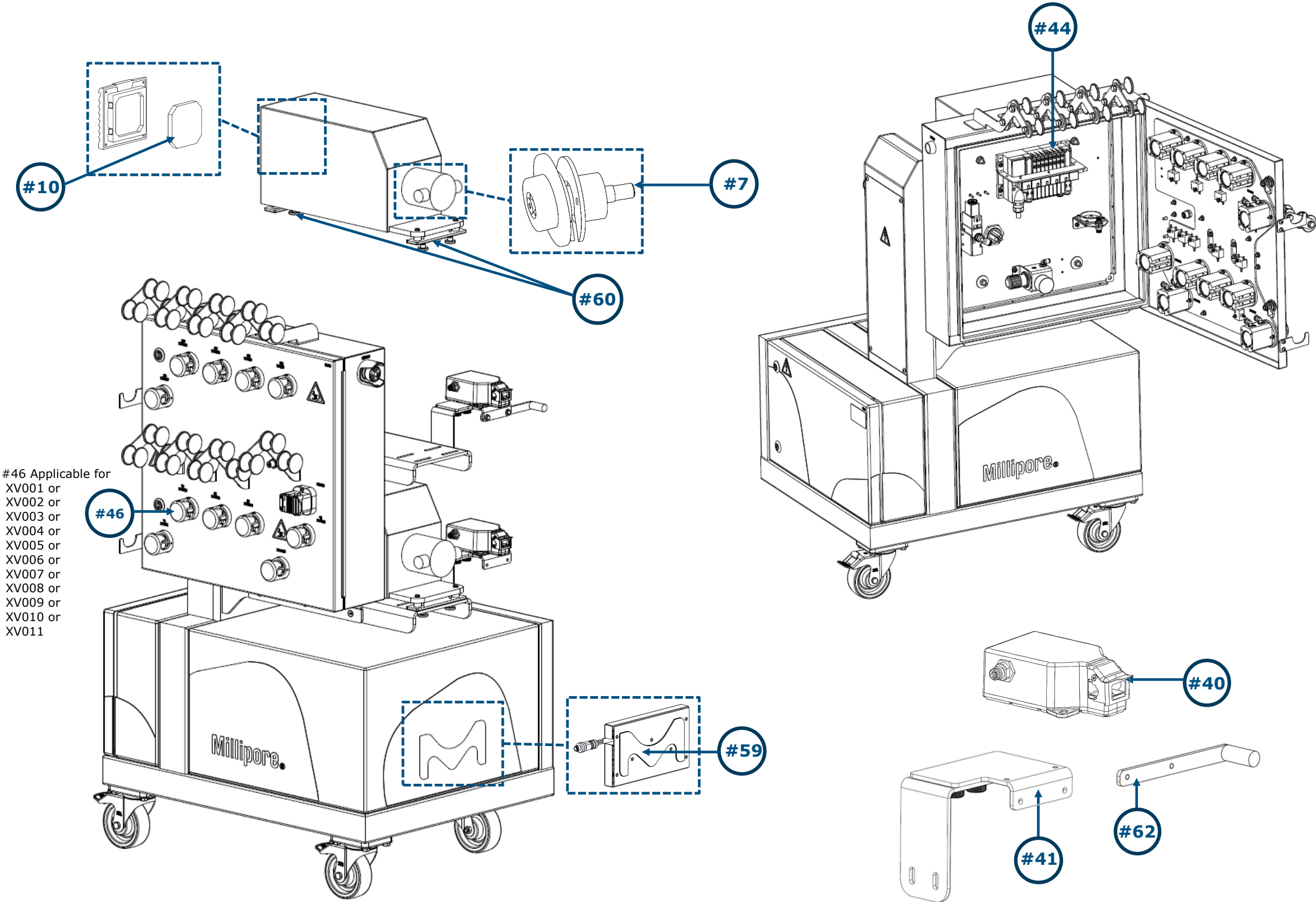

Sub-Assemblies Details

Mobius® Chrom 10 Pump Cart Parts

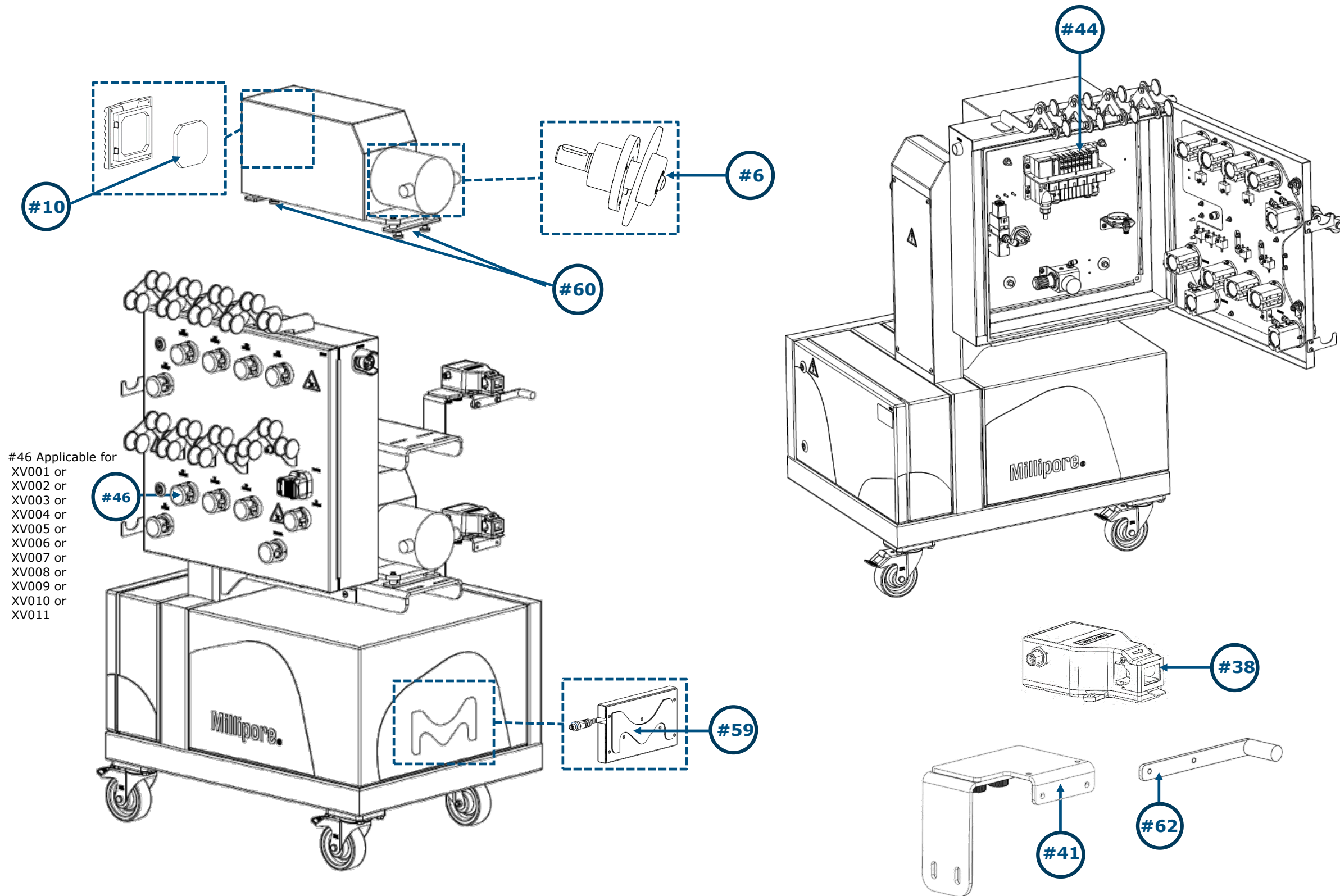

Sub-Assemblies Details

Mobius® Chrom 20 Pump Cart Parts

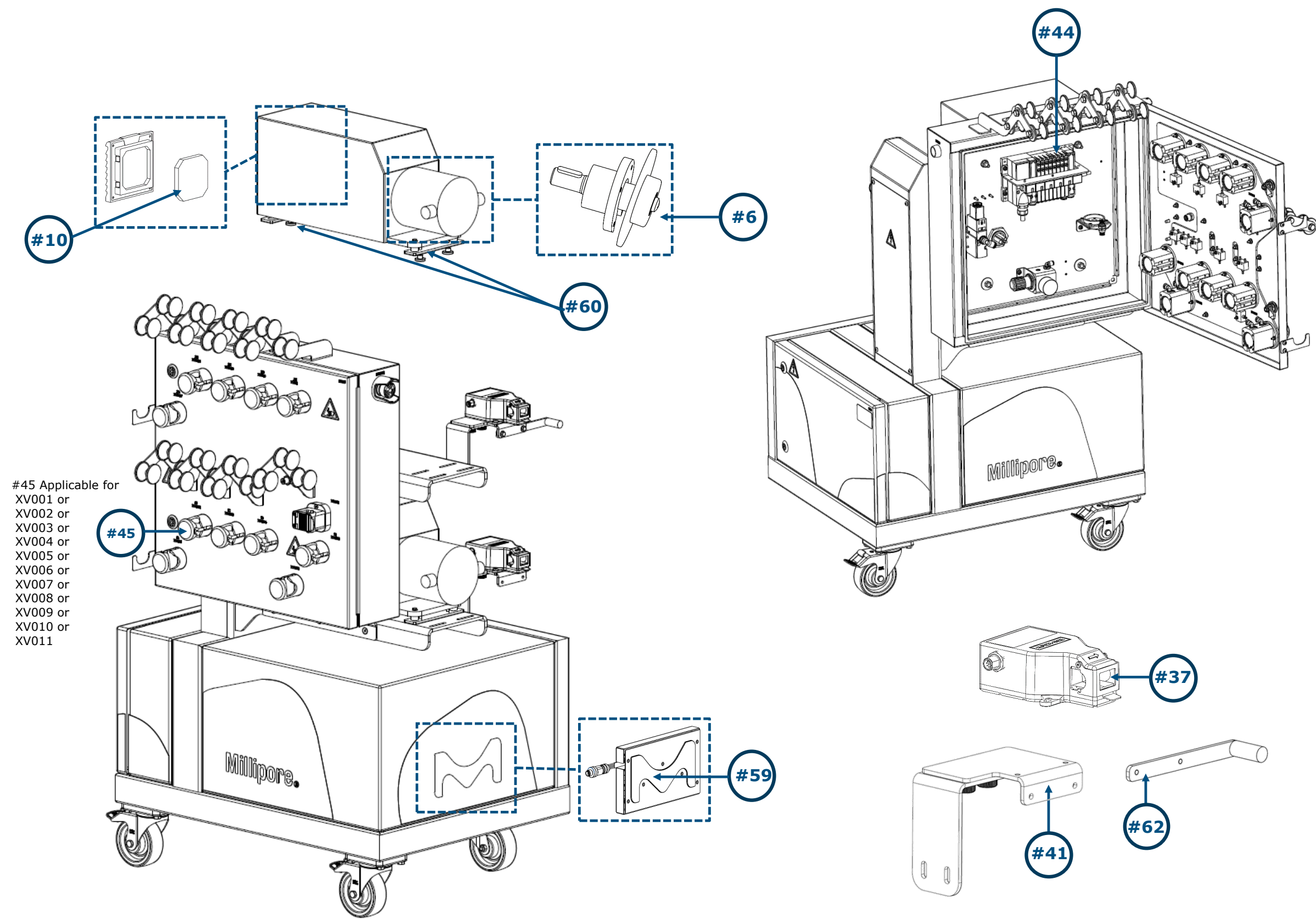

Sub-Assemblies Details

Mobius® Chrom 20 (In-Line Dilution) Pump Cart Parts

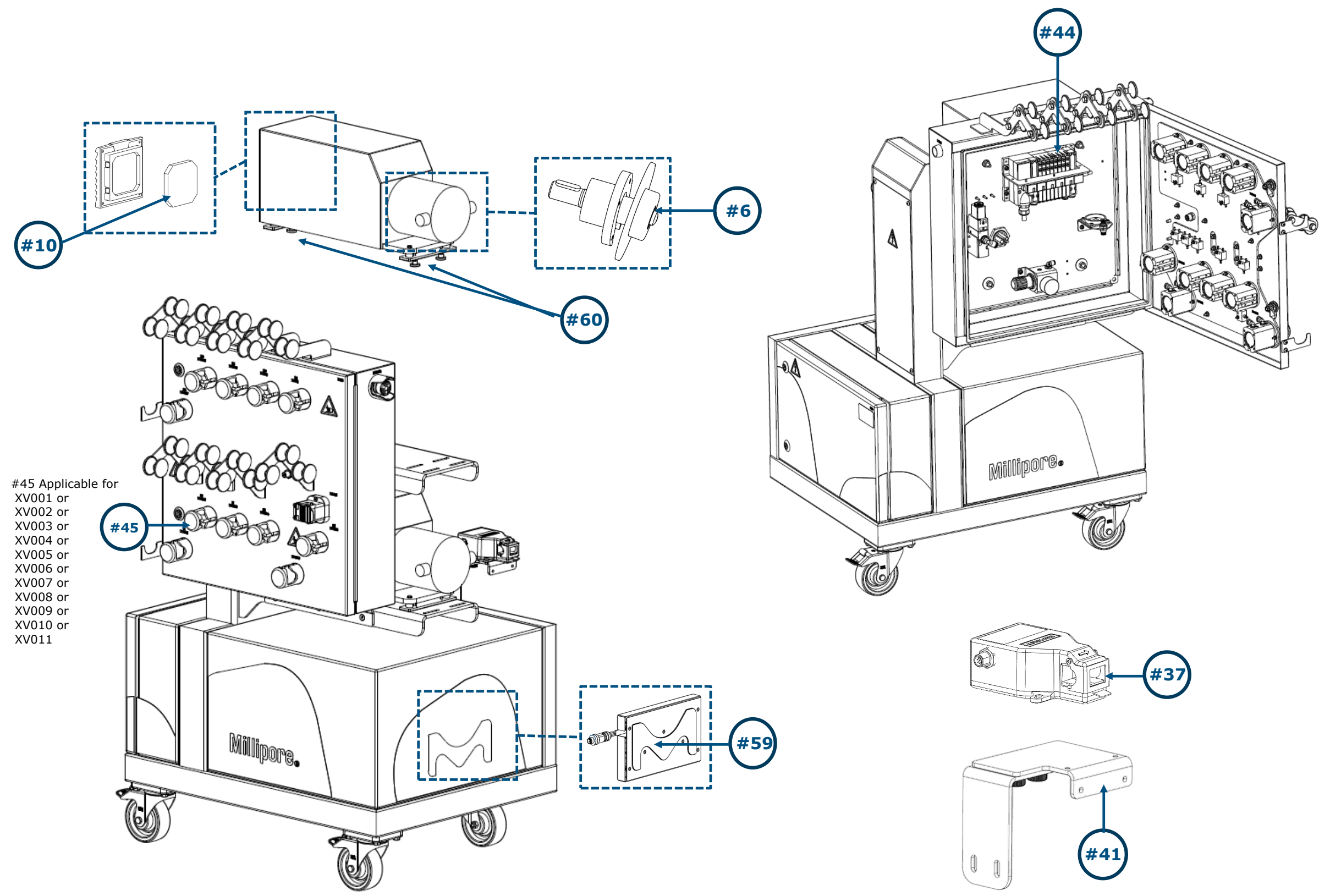

Sub-Assemblies Details

Mobius® Chrom Systems Pump Cart Ebox

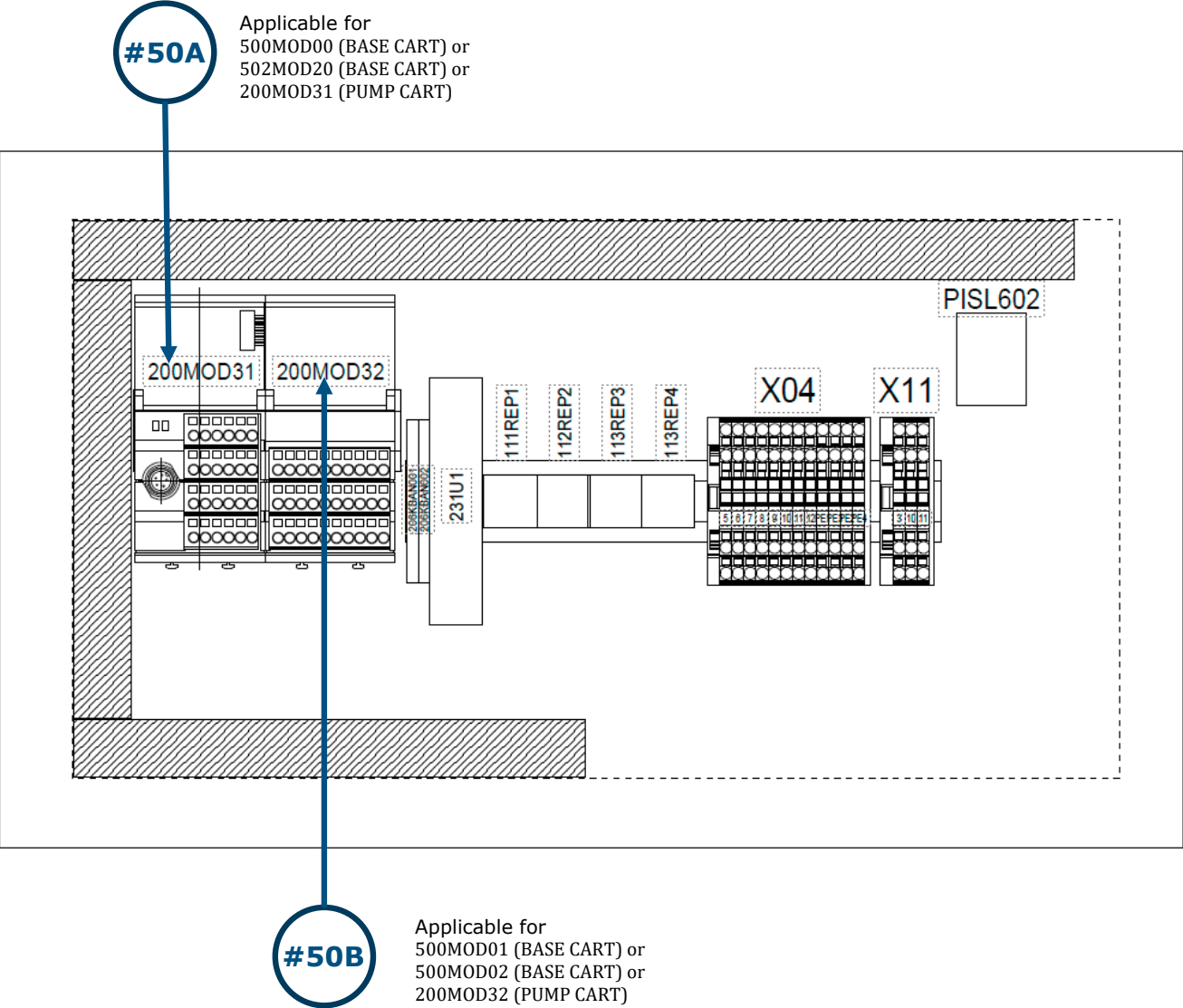

Sub-Assemblies Details

Mobius® Chrom Systems Pump Cart Ebox Door

Chrom 2 Pump Cart Ebox Door

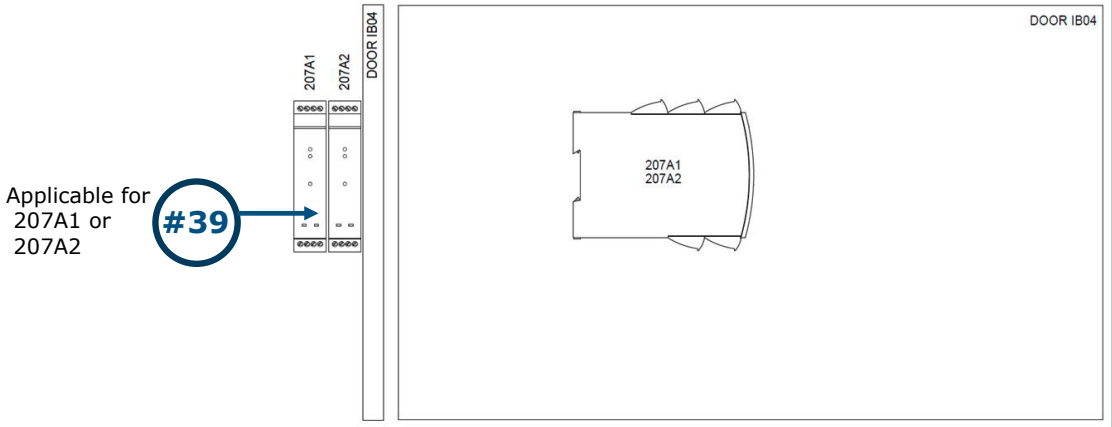

Chrom 10 Pump Cart Ebox Door

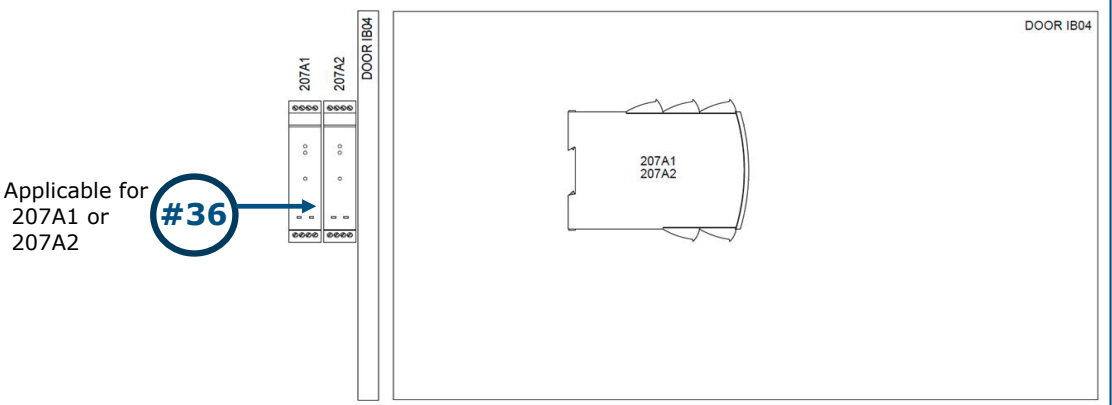

Chrom 20 Pump Cart Ebox Door

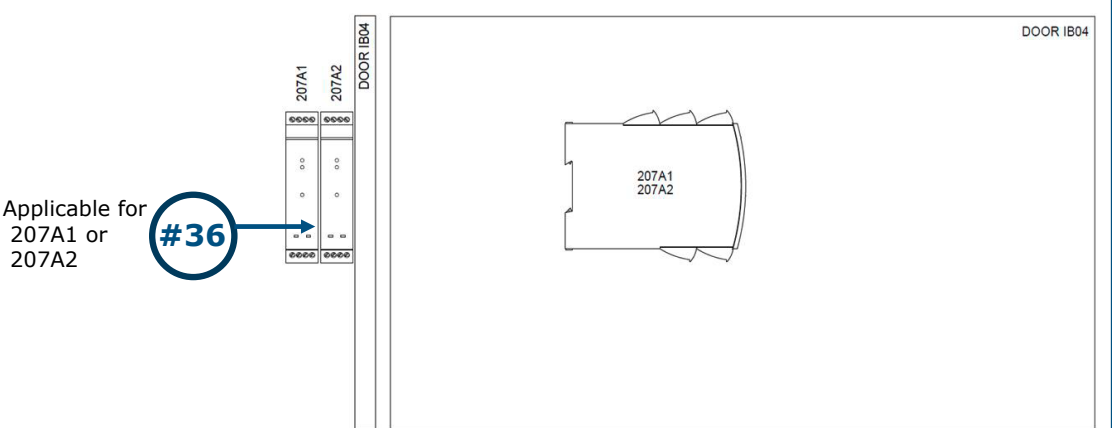

Chrom 20 Inline Dilution Pump Cart Ebox Door

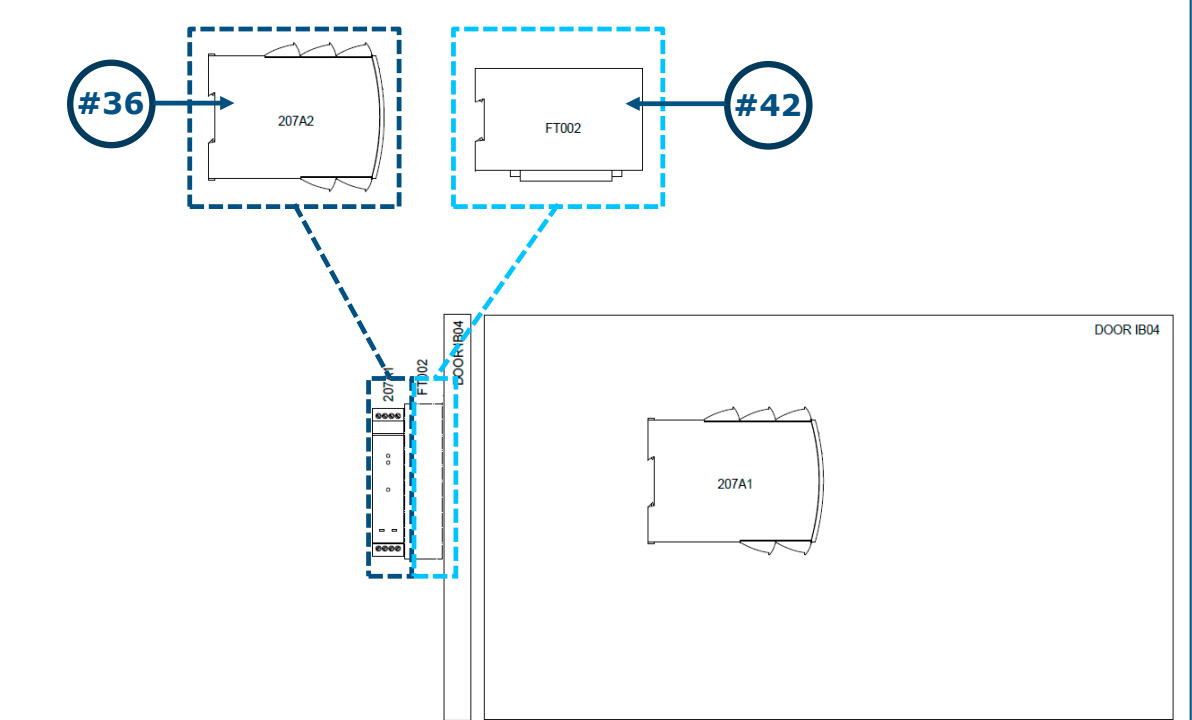

Sub-Assemblies Details

Mobius® Chrom 2 Clamshell Parts

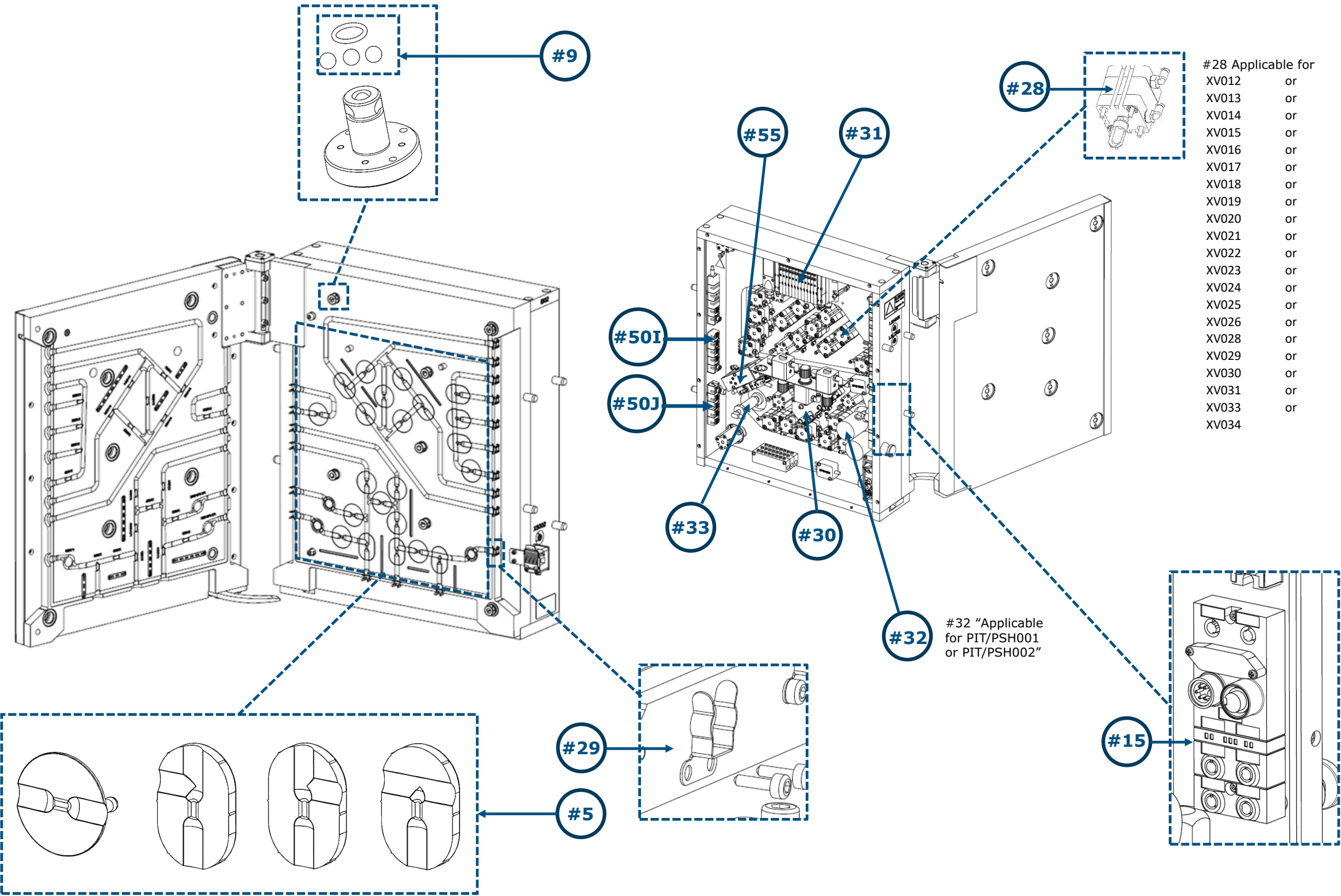

Sub-Assemblies Details

Mobius® Chrom 10 Clamshell Parts

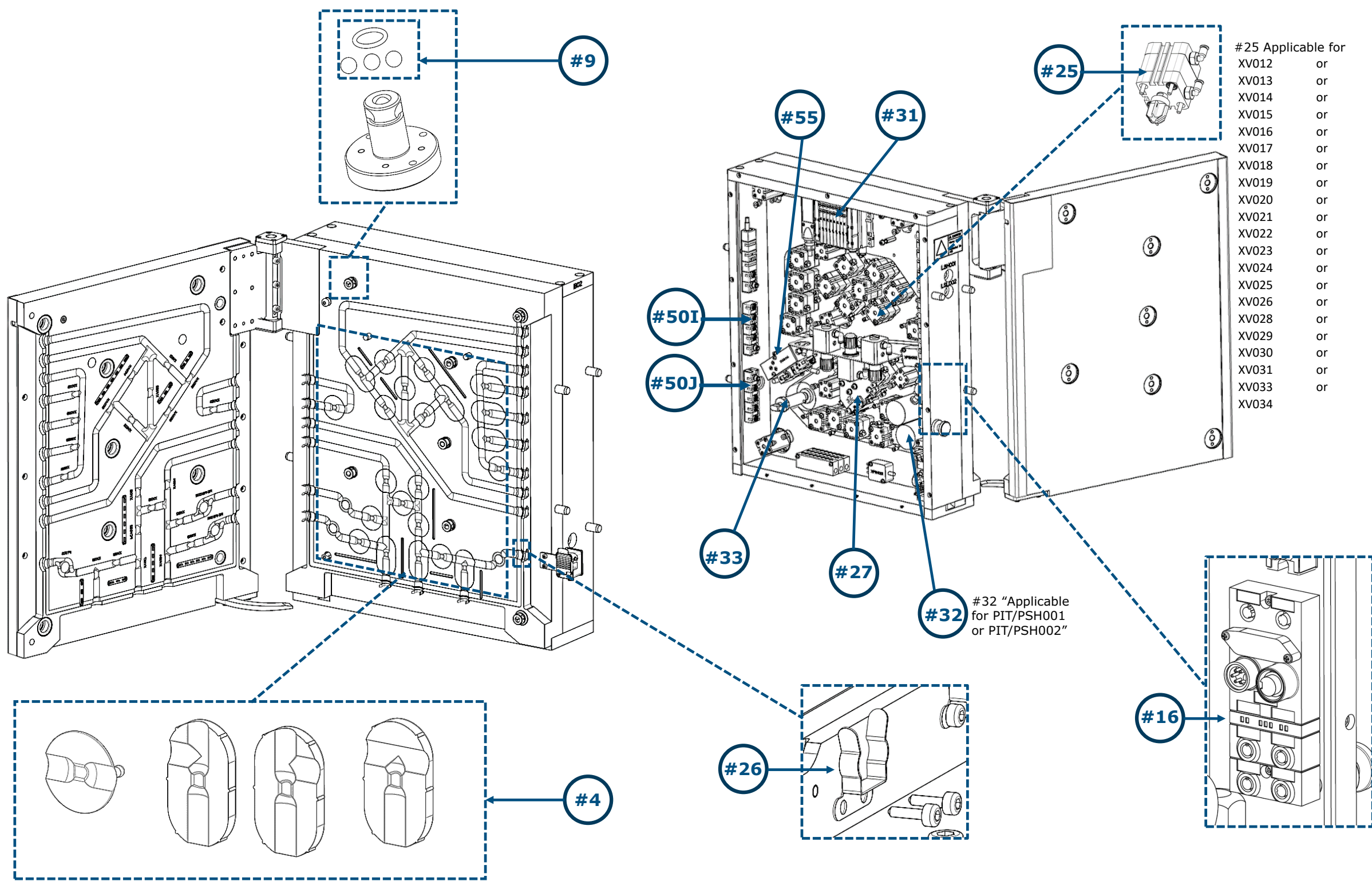

Sub-Assemblies Details

Mobius® Chrom 20 & Chrom 20 Inline Dilution Clamshell Parts

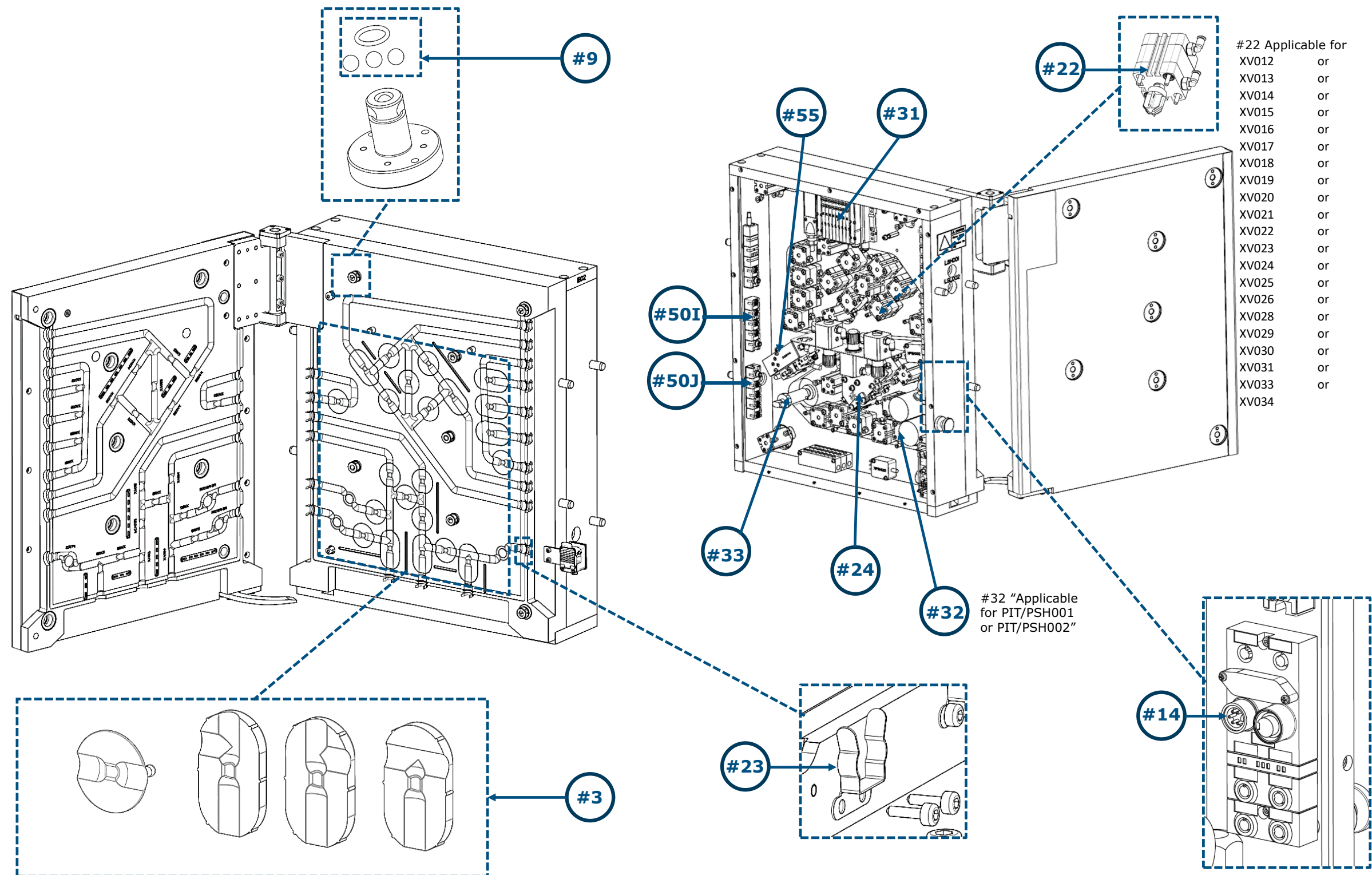

Sub-Assemblies Details

Instrumentation Parts

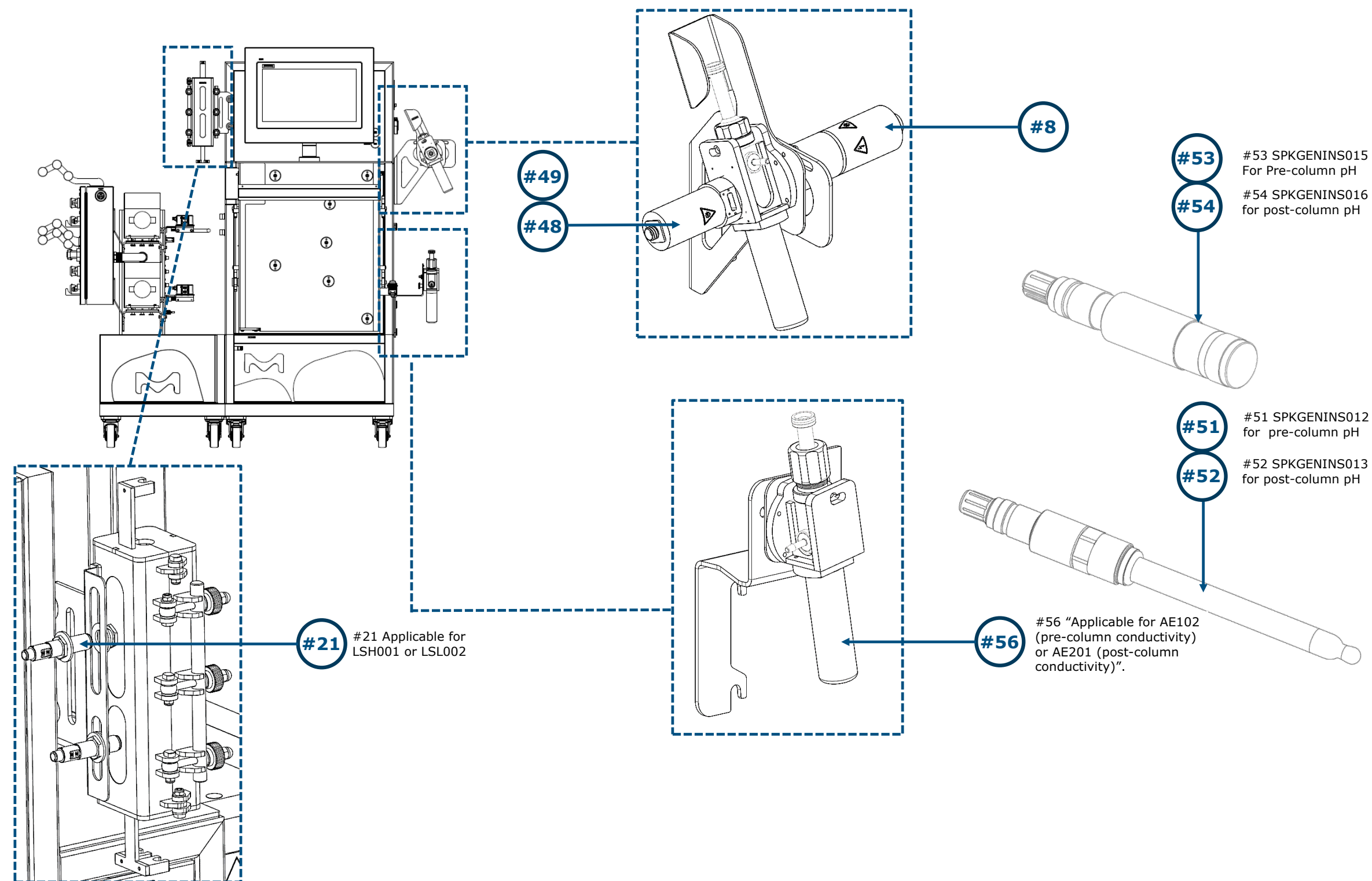

For more information, please visit www.SigmaAldrich.com

© 2024 Merck KGaA, Darmstadt, Germany and/or its affiliates. All Rights Reserved.
Merck, the Vibrant M, Millipore, Mobius and Flexware are trademarks of Merck KGaA, Darmstadt, Germany or its affiliates.
All other trademarks are the property of their respective owners. Detailed information on trademarks is available via publicly accessible resources.

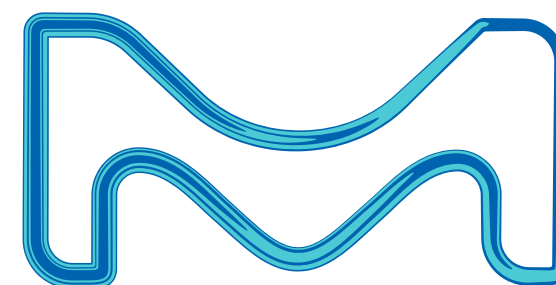

Lit. No. MK_CA12829EN Ver. 2.0
06/2024