

# MSOpener™

Manifold

## Maintenance Guide

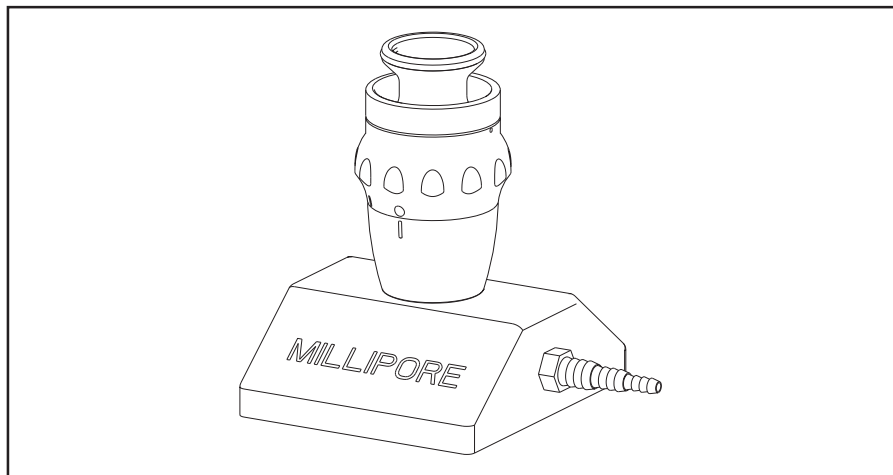

MILLIPORE

## To disassemble the MSOpener manifold:

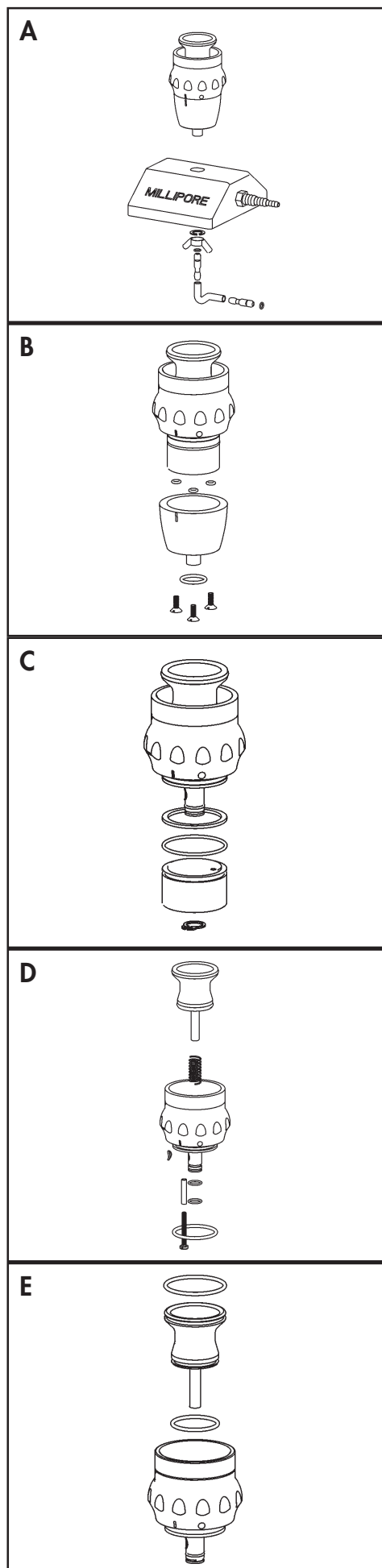

1. Remove the tubing from the underside of the manifold by gently pulling it out of the bottom port of the manifold. Unscrew the wing nut on the underside of the manifold.
2. Lift body of MSOpener manifold up and away from base.
3. Unscrew the three screws on the underside of the MSOpener body and pull up to remove the top section of the body.
4. Remove small ring at the end of the threaded rod and separate the top section to reveal and remove the gaskets.
5. Unscrew the screw, remove the small clips to reveal the head gasket, and separate the support head.
6. Unscrew the bottom of the support head and remove the small tubing. Change all gaskets revealed.
7. Re-assemble in reverse order after changing all gaskets.

## Technical Assistance

For more information, contact the Millipore office nearest you. In the U.S., call **1-800-MILLIPORE** (1-800-645-5476). Outside the U.S., see your Millipore laboratory catalogue for the phone number of the office nearest you. You can reach us by e-mail at [tech\\_service@millipore.com](mailto:tech_service@millipore.com) or visit our web site ([www.millipore.com](http://www.millipore.com)).

## Standard Warranty

**Millipore Corporation** ("Millipore") warrants its products will meet their applicable published specifications when used in accordance with their applicable instructions for a period of one year from shipment of the products. **MILLIPORE MAKES NO OTHER WARRANTY, EXPRESSED OR IMPLIED. THERE IS NO WARRANTY OF MERCHANTABILITY OR FITNESS FOR A PARTICULAR PURPOSE.** The warranty provided herein and the data, specifications and descriptions of Millipore products appearing in Millipore's published catalogues and product literature may not be altered except by express written agreement signed by an officer of Millipore. Representations, oral or written, which are inconsistent with this warranty or such publications are not authorized and if given, should not be relied upon.

In the event of a breach of the foregoing warranty, Millipore's sole obligation shall be to repair or replace, at its option, the applicable product or part thereof, provided the customer notifies Millipore promptly of any such breach. If after exercising reasonable efforts, Millipore is unable to repair or replace the product or part, then Millipore shall refund to the customer all monies paid for such applicable product or part. **MILLIPORE SHALL NOT BE LIABLE FOR CONSEQUENTIAL, INCIDENTAL, SPECIAL OR ANY OTHER INDIRECT DAMAGES RESULTING FROM ECONOMIC LOSS OR PROPERTY DAMAGE SUSTAINED BY ANY CUSTOMER FROM THE USE OF ITS PRODUCTS.**

# MILLIPORE

©2001 Millipore Corporation. All rights reserved. This publication or parts thereof may not be reproduced in any form without the written permission of the publishers.

Millipore is a registered trademark of the Millipore Corporation.  
MSOpener is a trademark of the Millipore Corporation