



Pellicon[®] 3 Filter Holder

User Guide

The M mark and Pellicon are registered trademarks of Merck KGaA, Darmstadt, Germany.

© 2008, 2015, 2017 Millipore SAS. All rights reserved.

00104781PU Rev 3, 03/2017

Introduction

The Filter Holder holds up to three Pellicon® 3 88 cm² cassettes.

The holder is shipped with a torque wrench and socket that are required for installation.

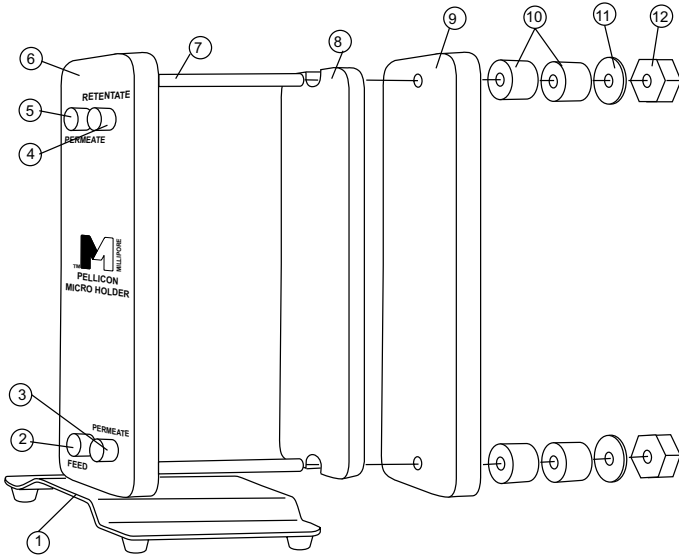

Figure 1: Pellicon holder exploded view

Key No.	Description
1	Base
2	Feed inlet port with male luer
3	Permeate (filtrate) outlet port with male luer
4	Retentate outlet port with male luer
5	Permeate (filtrate) port with male luer
6	Manifold
7	Tie rod
8	Pellicon® 3 filter cassette (user supplied)
9	End plate
10	Tie rod spacers
11	Washer
12	Nut

Installation

NOTE This holder is shipped with four plugs in the permeate and retentate ports. These plugs must be replaced by the connectors provided prior to use.

1. Remove the plugs in the permeate and retentate ports by rotating them counterclockwise.
2. Install the connectors by rotating them clockwise with an 8 mm spanner.
3. Loosen the nuts on the tie rods. Remove the nuts, washers, spacers, and end plate from the manifold.
4. Inspect the tie rods and nuts for signs of burrs or stripped threads. The nuts must turn freely on the tie rods to ensure proper tightening of the holder.
5. Slide the Pellicon® 3 Cassette onto the holder so that the tie rods pass through the cutouts in the Pellicon® 3 Cassette. Repeat to install one or two additional Pellicon® 3 Cassettes if required
6. Slide the end plate onto the tie rods and press the end plate against the filter.
7. Install the tie rod spacers, washers and nuts. Hand-tighten the nuts, alternating from one nut to the other nut.

NOTE Uneven tightening of the nuts can damage the Pellicon® Cassette. Nonparallel plates or compression of the filters at one end can cause leakage.

8. Tighten the end plate using the torque wrench and socket provided. The torque wrench is preset to 180–200 inch-pounds (20.3–22.6 newton-meters). Verify the torque wrench setting prior to use.
9. Attach the deep socket to the torque wrench by firmly pressing the deep socket onto the torque wrench drive.

10. Brace the holder with one hand. With a continuous motion, turn each nut $\frac{1}{4}$ turn with the torque wrench, alternating from one nut to the other until the torque wrench “clicks” which will indicate it has reached the set force.
11. Wait five to ten minutes, then re-torque to 180–200 inch-pounds.
12. Re-torque to a maximum of 200 inch-pounds as needed to create a liquid-tight seal.

CAUTION

Non-uniform tightening of the nuts can damage the filter. Non-parallel plates or compression of the filter(s) at one end may result in leakage.

We provide information and advice to our customers on application technologies and regulatory matters to the best of our knowledge and ability, but without obligation or liability. Existing laws and regulations are to be observed in all cases by our customers. This also applies in respect to any rights of third parties. Our information and advice do not relieve our customers of their own responsibility for checking the suitability of our products for the envisaged purpose.

For more information and documentation please contact:

Merck KGaA, Darmstadt, Germany
Corporation with General Partners
Frankfurter Str. 250
64293 Darmstadt, Germany
Phone: + 49 6151-72 0

For requests from USA and Canada please contact:

EMD Millipore Corporation
A subsidiary of Merck KGaA, Darmstadt, Germany
290 Concord Road
Billerica, MA 01821, USA
Phone: 1-800-645-5476

Standard Product Warranty

The applicable warranty for the products listed in this publication may be found at www.millipore.com/terms (within the “Terms and Conditions of Sale” applicable to your purchase transaction).